

REVISIONS		
REV	DESCRIPTION	DATE
B	Was .028 wall, chg'd length	9/8/2003

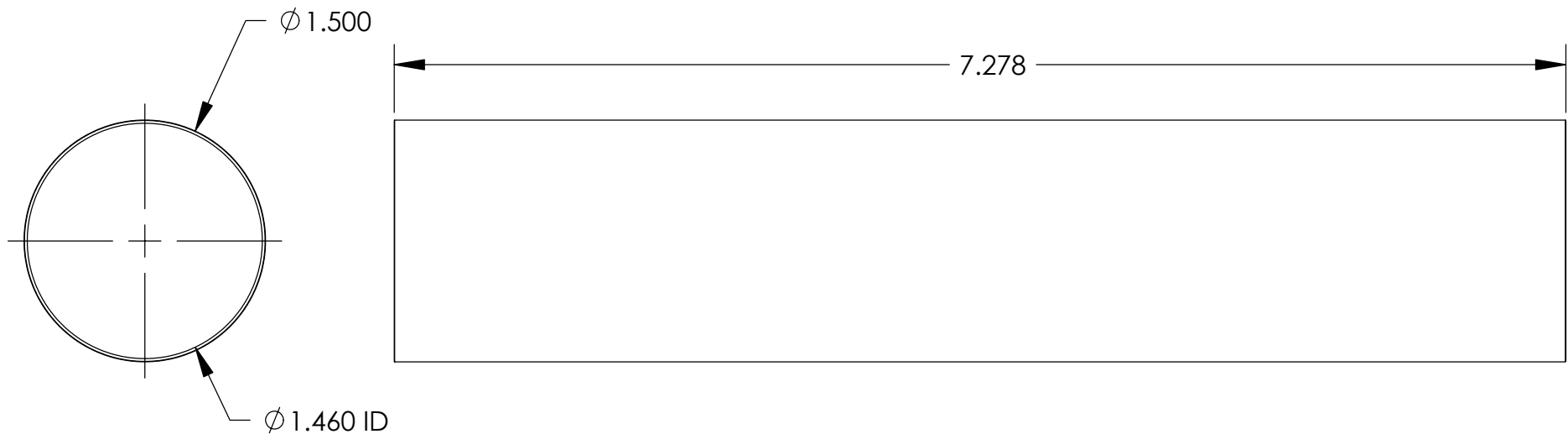

NOTES:

1. MAKE FROM 1.500" X .020 WALL TUBE.

UNLESS OTHERWISE SPECIFIED:						<div>High Precision Devices</div> <div>1668 Valtec Lane, Suite C, Boulder, Colorado 80301</div> <div>Phone: (303) 447-2558 Fax: (303) 447-2548 Web Site: www.hpd-online.com</div>									
DIMENSIONS ARE IN INCHES DECIMAL TOLERANCES:															
.X	±.030	.XX	±.015	.XXX	±.005										
ANGULAR TOL: ± 1° SURFACE ROUGHNESS:63/√						TITLE: <div>p02101-091 tube, still</div>									
INTERNAL AND EXTERNAL SURFACE INTERSECTIONS SHALL BE UNIFORMLY FINISHED WITH CHAMFER .005/.010 X 45° OR RADIUS .005/.010. CHAMFER ALL THREADED HOLES 110° OF MAJOR DIAMETER X 45°															
CONFIGURATION:						00-Default									
MATERIAL:						SIZE		QTY PER ASSM:		SCALE:		SHEET		REV	
304 SST Tube						A		1		1:1		1 OF 1		B	
FINISH:						DATE:		DRAWN BY:							
NONE						5/20/2004		C. Danaher							